

Hotel Bel-Air  
*Garden Ballroom*  
*Ground floor*

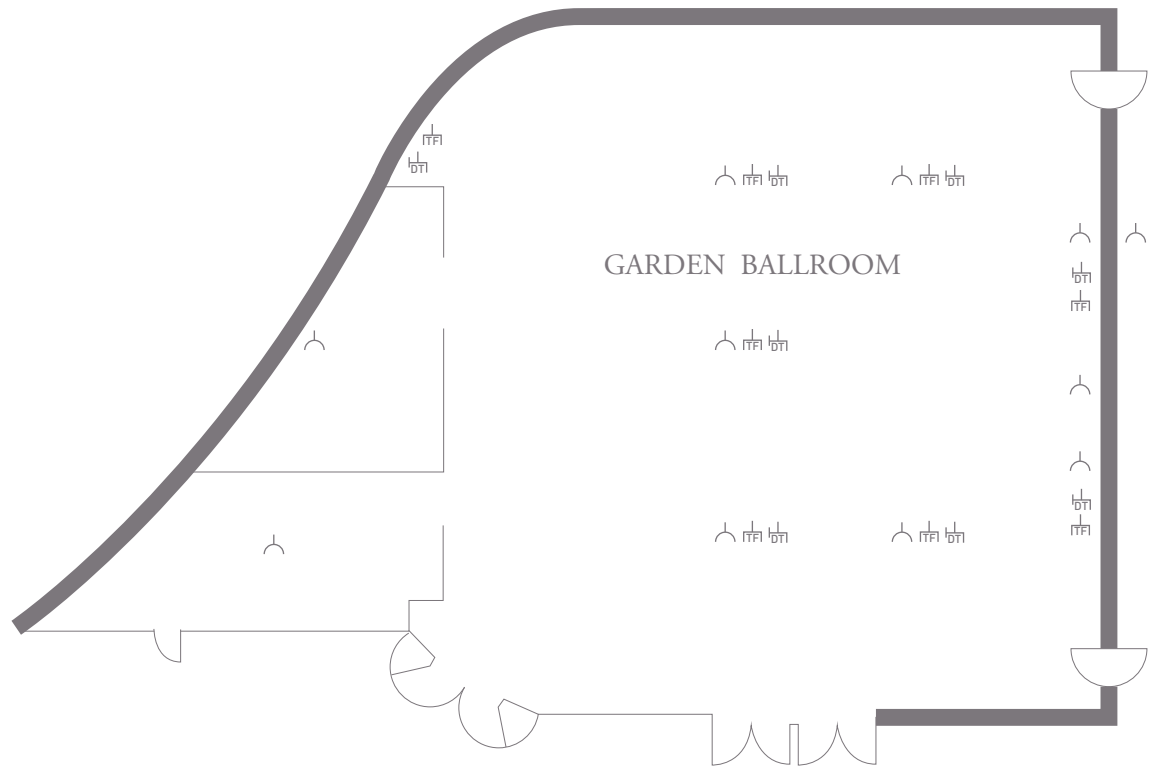

GARDEN BALLROOM	Metres	Feet
Area	247m <sup>2</sup>	2,660ft <sup>2</sup>
Ceiling height – centre	4.5m	15'
Ceiling height – sides	4m	13'
Ceiling height – stage	3m	10'
Length (maximum)	15m	49'2"
Width (maximum)	15m	49'2"

Capacities	Maximum
Reception	350
Theatre	300
Banquet round	210
Dinner dance	180
Classroom	120
Conference	40
U-shape	50
Hollow square	72

Key	Symbol
Electricity socket	⌒
LAN port	⌒—
Telephone socket	⌒— —○