

# The Dorchester

## *Business Suite – mezzanine floor*

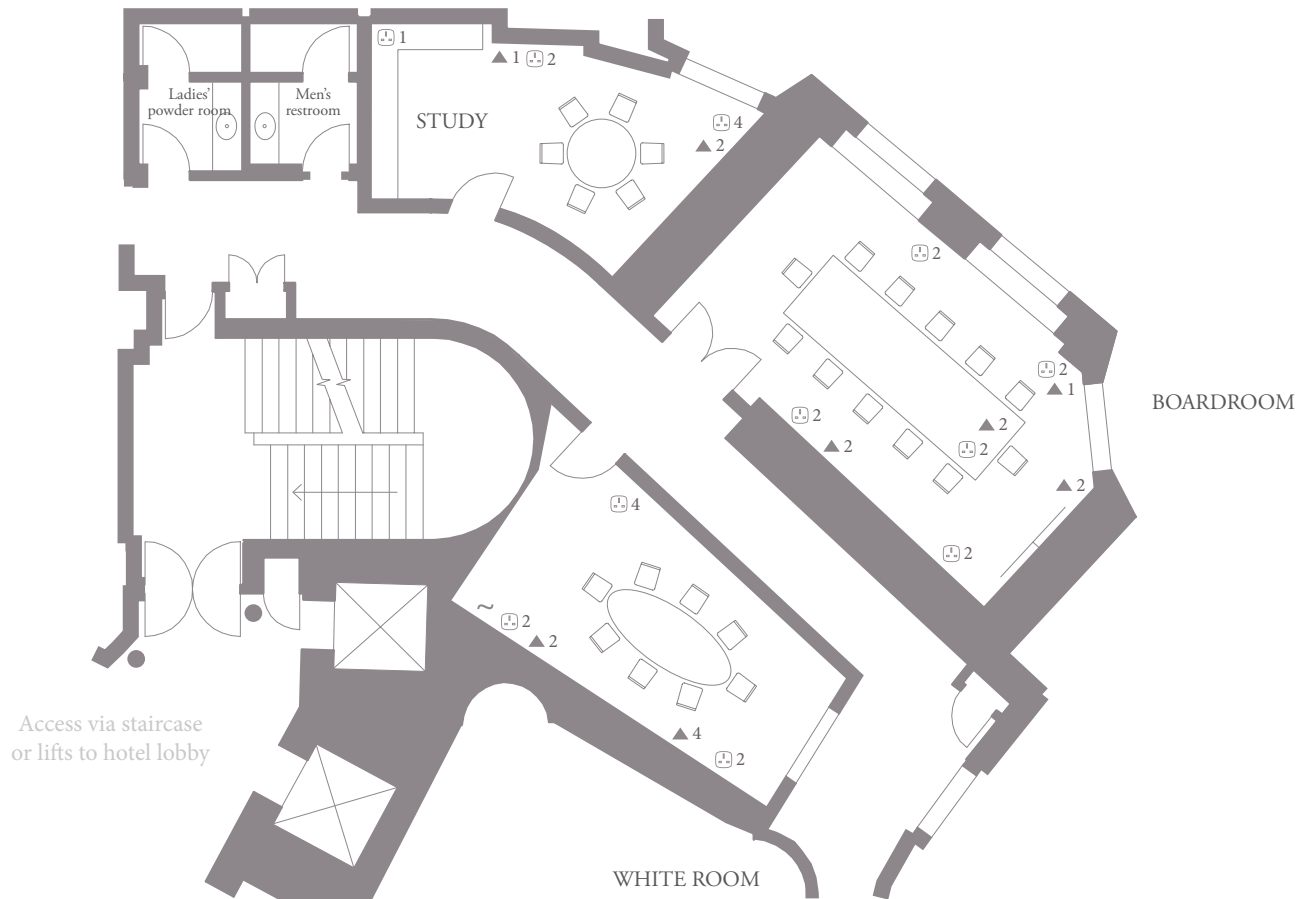

Key	Symbol
Power Socket	⊕
Cat 5 / IP / ISDN	▲
VGA	~

BOARDROOM	Metric	Imperial
Area	28 sq m	301 sq ft
Ceiling height (highest)	2.26m	7' 4"
Ceiling height (lowest)	2.26m	7' 4"
Length (maximum)	7.2m	23' 7"
Width (maximum)	4m	13' 1"

Capacities	Maximum
Breakfast	12
Boardroom	12
Dinner	12
Lunch	12

STUDY	Metric	Imperial
Area	16 sq m	172 sq ft
Ceiling height (highest)	2.25m	7' 4"
Ceiling height (lowest)	2.25m	7' 4"
Length (maximum)	5m	16' 4"
Width (maximum)	3.2m	10' 5"

Capacities	Maximum
Breakfast	6
Boardroom	6
Dinner	6
Lunch	6

WHITE ROOM	Metric	Imperial
Area	13 sq m	139 sq ft
Ceiling height (highest)	2.25m	7' 4"
Ceiling height (lowest)	2.25m	7' 4"
Length (maximum)	4.4m	14' 5"
Width (maximum)	3m	9' 10"

Capacities	Maximum
Breakfast	8
Boardroom	8
Dinner	8
Lunch	8