

The Dorchester
Park Suite Left
Mezzanine floor

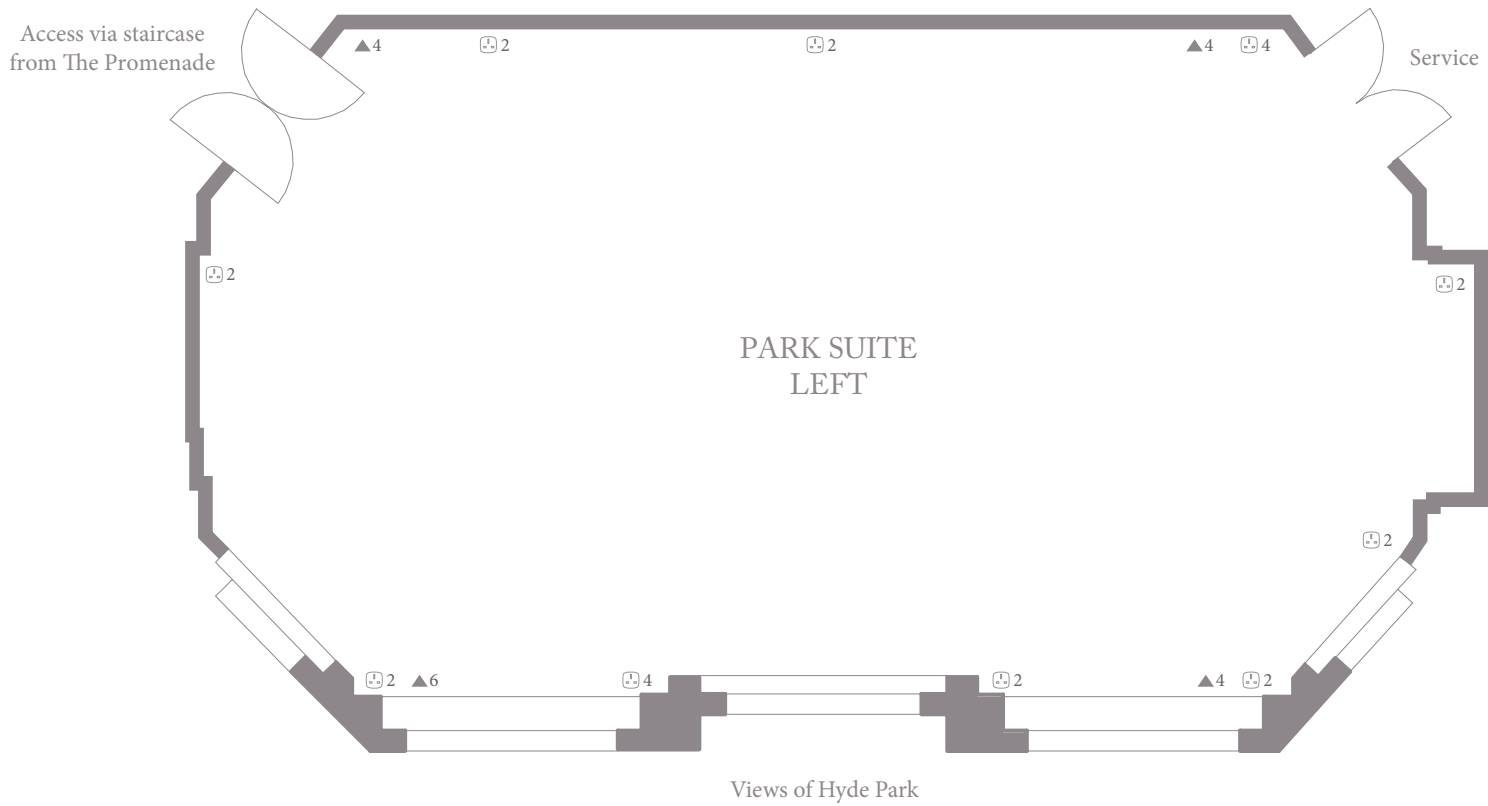

PARK SUITE LEFT	Metres	Feet
Area	93m ²	1,001ft ²
Ceiling height (highest)	2.55m	8'4"
Ceiling height (lowest)	2.55m	8'4"
Length (maximum)	13.2m	43'3"
Width (maximum)	7.1m	23'3"

Capacities	Maximum
Breakfast	60
Boardroom	36
Cabaret	42
Classroom	50
Cocktails	100
Dinner	60
Dinner dance	50
Hollow square	42
Lunch	60
Theatre	60
U-shape	36

Key	Symbol
Power socket	⊞
Cat 5 / IP / ISDN	▲

The Dorchester
Park Suite Right
Mezzanine floor

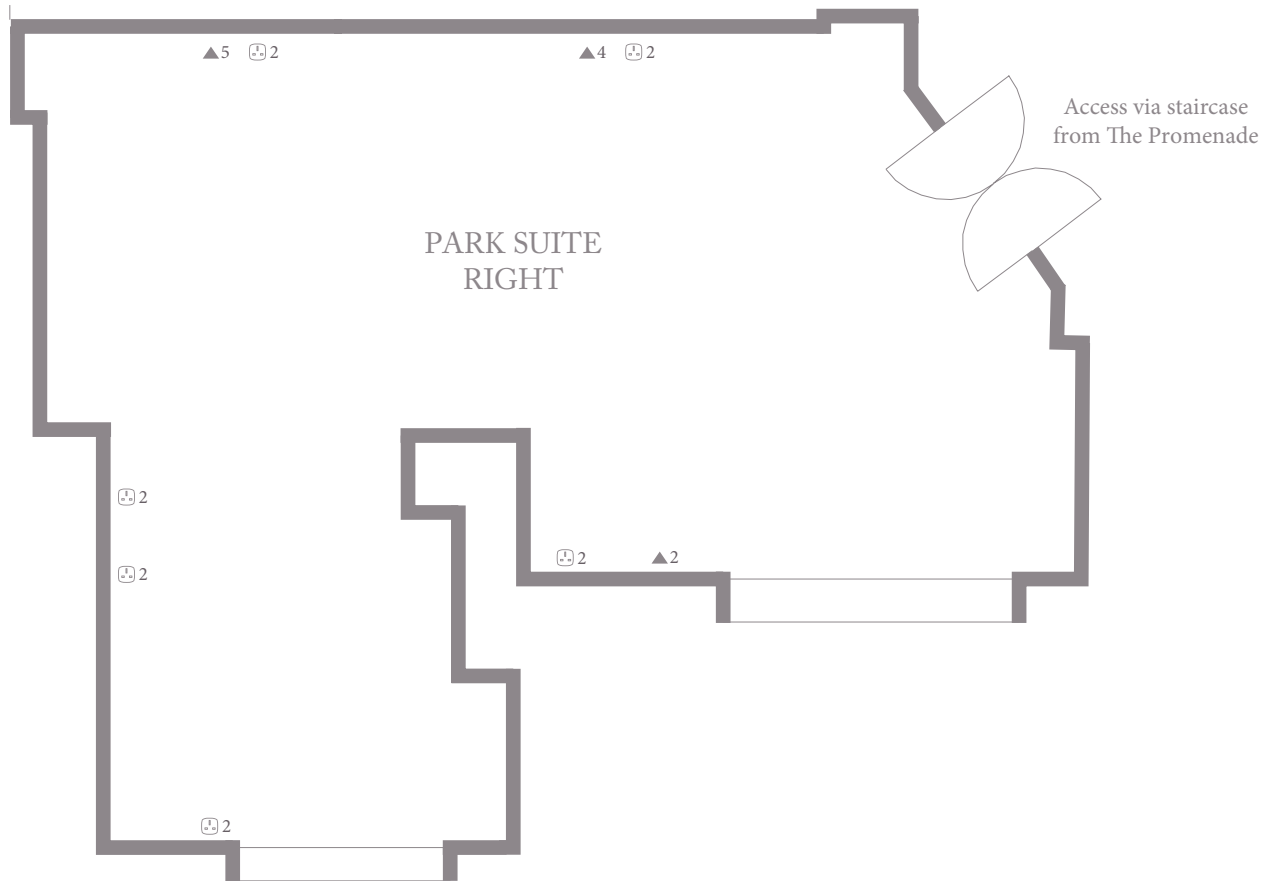

Views of Hyde Park

PARK SUITE RIGHT	Metres	Feet
Area	76m ²	818ft ²
Ceiling height (highest)	2.56m	8'4"
Ceiling height (lowest)	2.2m	7'2"
Length (maximum)	9.57m	31'4"
Width (maximum)	8m	26'2"

Capacities	Maximum
Breakfast	30
Boardroom	22
Cabaret	-
Classroom	-
Cocktails	60
Dinner	30
Dinner dance	-
Hollow square	-
Lunch	30
Theatre	30
U-shape	-

Key	Symbol
Power socket	⊞
Cat 5 / IP / ISDN	▲